

# Sammamish-Juanita Transmission Line Project

## SIMULATION OVERVIEW

- ① PHOTO VIEWPOINT
- SUBSTATION
- TRANSMISSION LINE

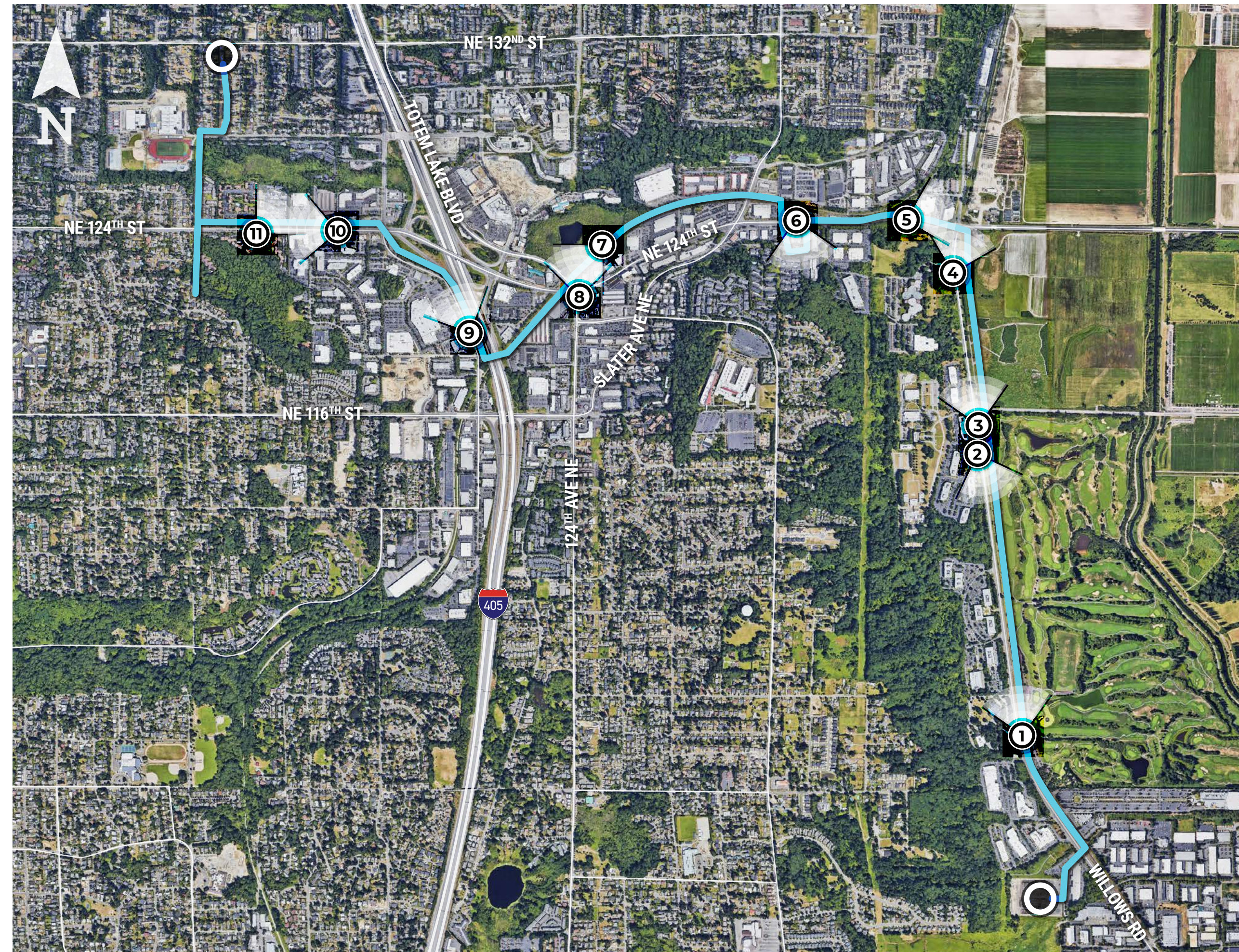



# Sammamish–Juanita Transmission Line Project

## SIMULATION VIEWPOINT 1

Date: 7/2/2015

Time: 9:16 AM

Viewing Direction: NORTH

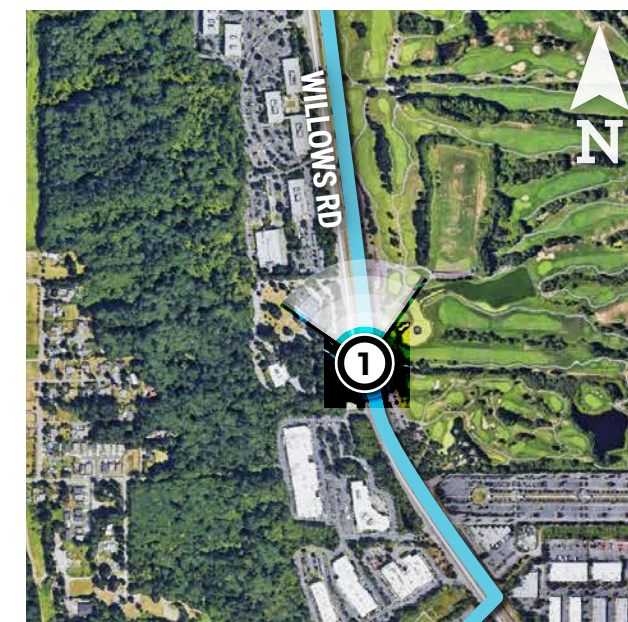

① PHOTO VIEWPOINT

● SUBSTATION

— TRANSMISSION LINE



EXISTING CONDITIONS



PROPOSED CONDITIONS

Photo simulations created by:



Photo simulations are for demonstration purposes only, and do not depict the exact location of any project improvements. Final design is subject to change pending public, utility, and regulatory review. These photo simulations are intended to depict before and after conditions of the transmission line based on the most current design. Background imagery and landscaping in the after images may not accurately depict actual conditions once the project is constructed.



# Sammamish–Juanita Transmission Line Project

## SIMULATION VIEWPOINT 2

Date: 7/30/2015

Time: 9:43 AM

Viewing Direction: SOUTH

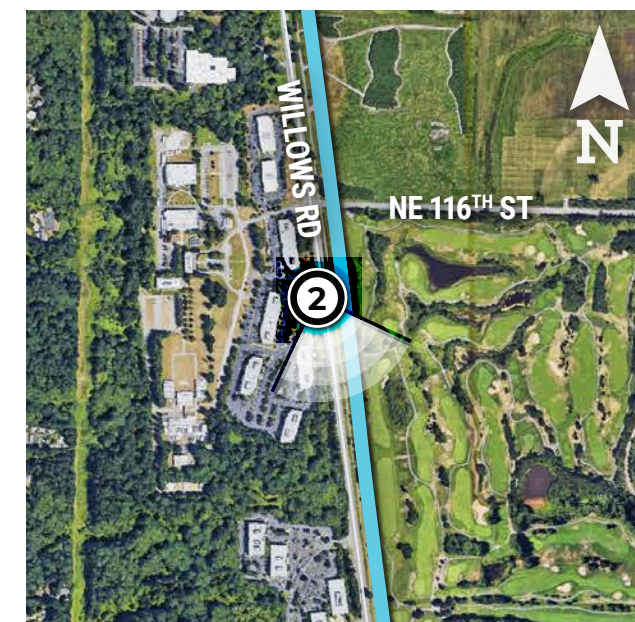

① PHOTO VIEWPOINT

● SUBSTATION

— TRANSMISSION LINE

Photo simulations created by:



EXISTING CONDITIONS



PROPOSED CONDITIONS

Photo simulations are for demonstration purposes only, and do not depict the exact location of any project improvements. Final design is subject to change pending public, utility, and regulatory review. These photo simulations are intended to depict before and after conditions of the transmission line based on the most current design. Background imagery and landscaping in the after images may not accurately depict actual conditions once the project is constructed.



# Sammamish–Juanita Transmission Line Project

## SIMULATION **3** VIEWPOINT

Date: 9/19/2019

Time: 1:28 PM

Viewing Direction: NORTH

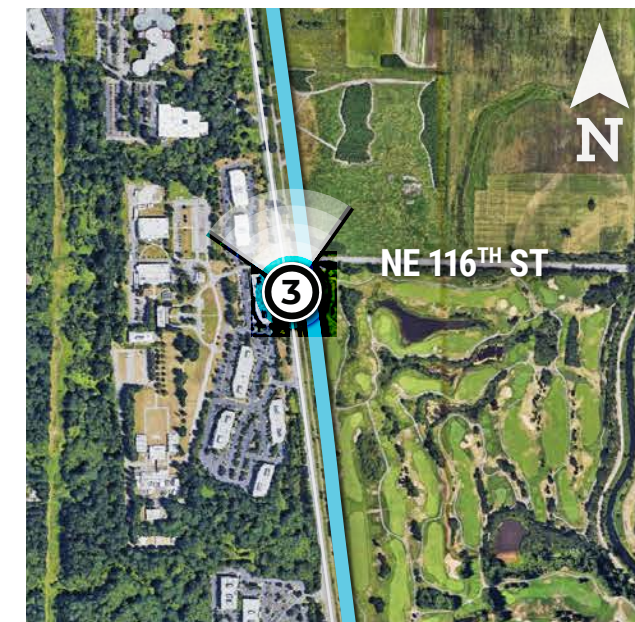

- ① PHOTO VIEWPOINT
- SUBSTATION
- TRANSMISSION LINE

Photo simulations created by:



Photo simulations are for demonstration purposes only, and do not depict the exact location of any project improvements. Final design is subject to change pending public, utility, and regulatory review. These photo simulations are intended to depict before and after conditions of the transmission line based on the most current design. Background imagery and landscaping in the after images may not accurately depict actual conditions once the project is constructed.



# Sammamish–Juanita Transmission Line Project

## SIMULATION VIEWPOINT 4

Date: 9/19/2019

Time: 1:47 PM

Viewing Direction: NORTH



① PHOTO VIEWPOINT

○ SUBSTATION

— TRANSMISSION LINE

Photo simulations created by:



EXISTING CONDITIONS



PROPOSED CONDITIONS

GALVANIZED

Photo simulations are for demonstration purposes only, and do not depict the exact location of any project improvements. Final design is subject to change pending public, utility, and regulatory review. These photo simulations are intended to depict before and after conditions of the transmission line based on the most current design. Background imagery and landscaping in the after images may not accurately depict actual conditions once the project is constructed.



# Sammamish–Juanita Transmission Line Project

## SIMULATION VIEWPOINT 5

Date: 9/19/2019

Time: 2:10 PM

Viewing Direction: EAST

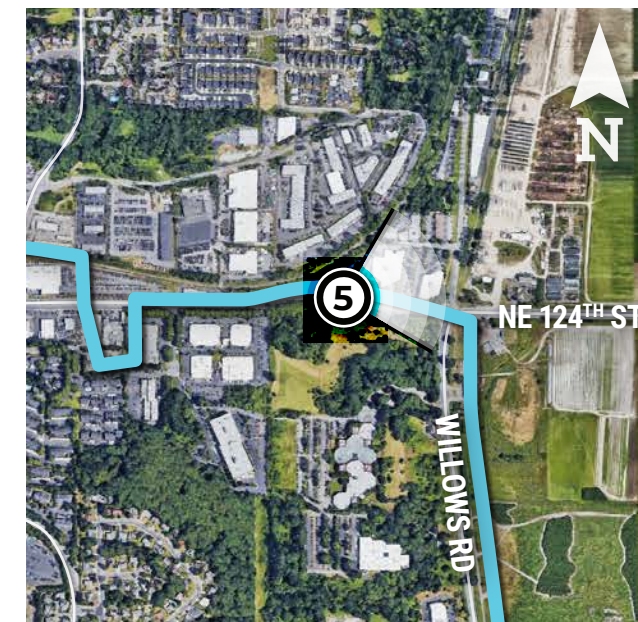



-  PHOTO VIEWPOINT
-  SUBSTATION
-  TRANSMISSION LINE

Photo simulations created by:



**EXISTING CONDITIONS**

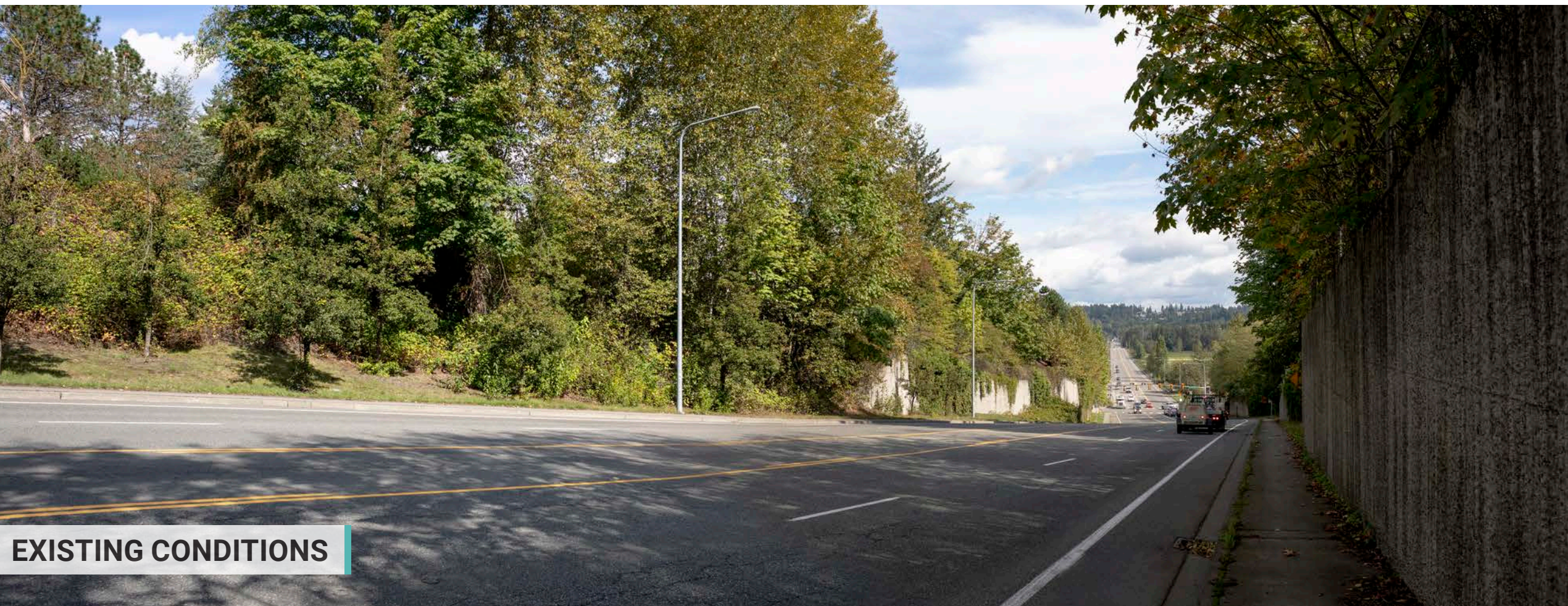
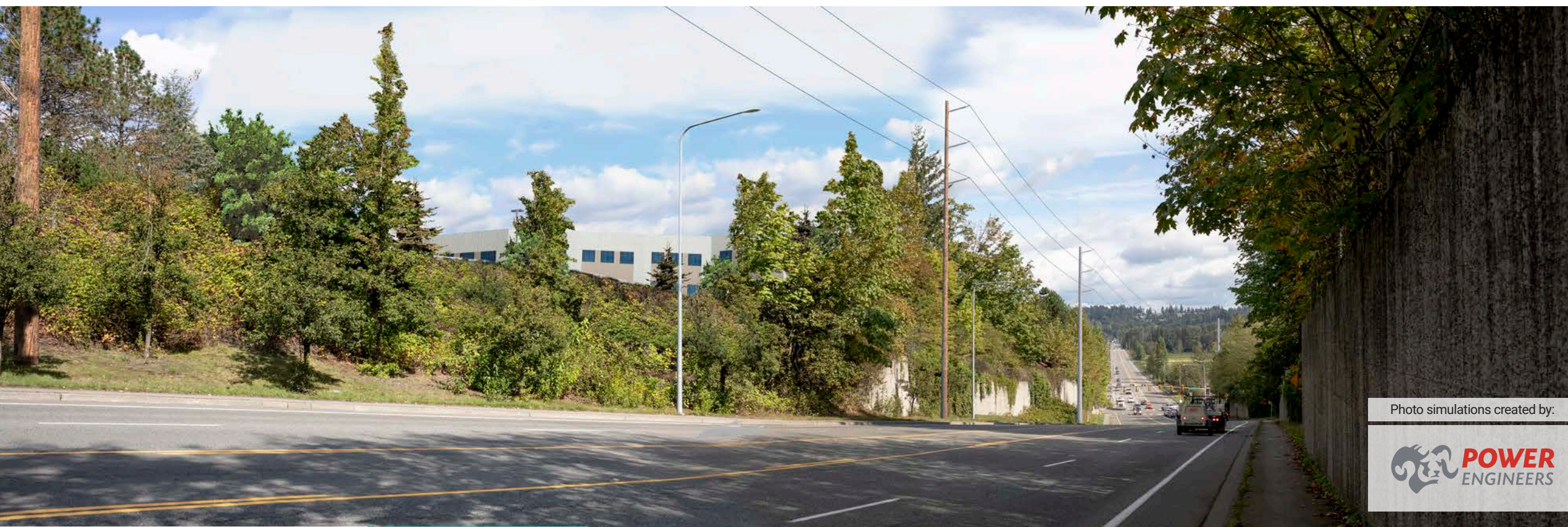

**PROPOSED CONDITIONS**

**GALVANIZED**

Photo simulations are for demonstration purposes only, and do not depict the exact location of any project improvements. Final design is subject to change pending public, utility, and regulatory review. These photo simulations are intended to depict before and after conditions of the transmission line based on the most current design. Background imagery and landscaping in the after images may not accurately depict actual conditions once the project is constructed.



# Sammamish–Juanita Transmission Line Project

## SIMULATION VIEWPOINT 6

Date: 9/19/2019

Time: 2:23 PM

Viewing Direction: SOUTH

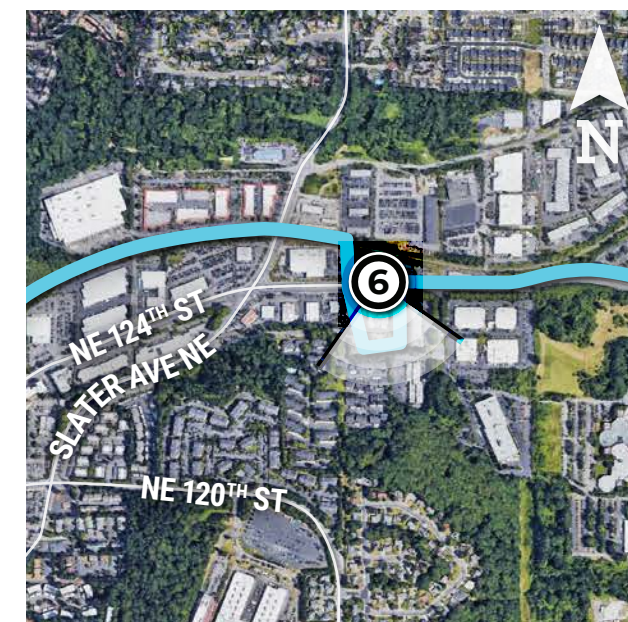



-  PHOTO VIEWPOINT
-  SUBSTATION
-  TRANSMISSION LINE

Photo simulations created by:



**EXISTING CONDITIONS**



**PROPOSED CONDITIONS**

Photo simulations are for demonstration purposes only, and do not depict the exact location of any project improvements. Final design is subject to change pending public, utility, and regulatory review. These photo simulations are intended to depict before and after conditions of the transmission line based on the most current design. Background imagery and landscaping in the after images may not accurately depict actual conditions once the project is constructed.



# Sammamish-Juanita Transmission Line Project

## SIMULATION 7 VIEWPOINT

Date: 9/19/2019

Time: 3:01 PM

Viewing Direction: SOUTHWEST

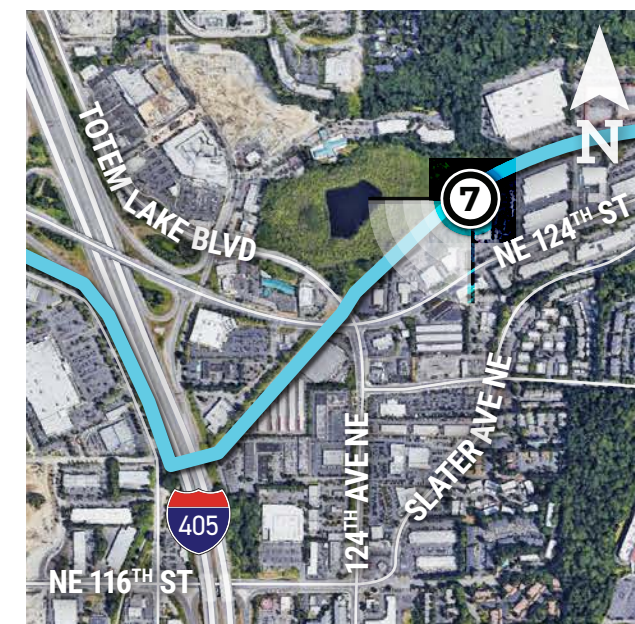

① PHOTO VIEWPOINT

● SUBSTATION

— TRANSMISSION LINE

Photo simulations created by:



EXISTING CONDITIONS



PROPOSED CONDITIONS

GALVANIZED

Photo simulations are for demonstration purposes only, and do not depict the exact location of any project improvements. Final design is subject to change pending public, utility, and regulatory review. These photo simulations are intended to depict before and after conditions of the transmission line based on the most current design. Background imagery and landscaping in the after images may not accurately depict actual conditions once the project is constructed.



# Sammamish–Juanita Transmission Line Project

## SIMULATION 8 VIEWPOINT 8

Date: 9/19/2019  
Time: 2:42 PM  
Viewing Direction: NORTH

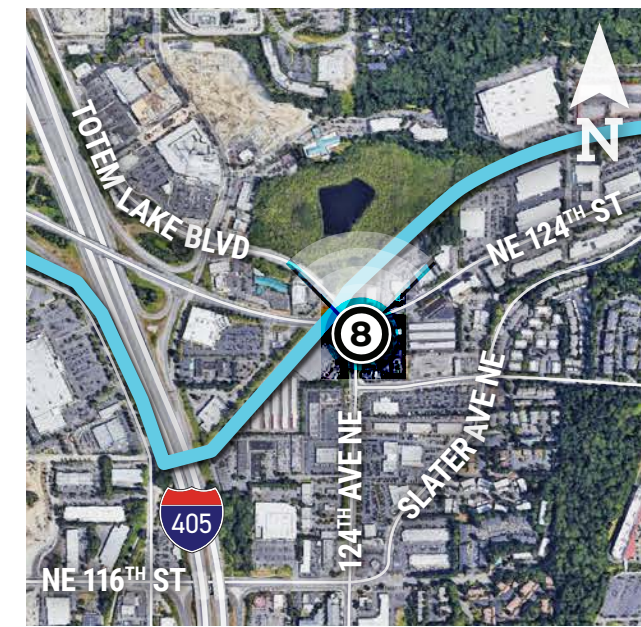

- ① PHOTO VIEWPOINT
- SUBSTATION
- TRANSMISSION LINE

Photo simulations created by:  
**POWER ENGINEERS**



**EXISTING CONDITIONS**



**PROPOSED CONDITIONS GALVANIZED**

Photo simulations are for demonstration purposes only, and do not depict the exact location of any project improvements. Final design is subject to change pending public, utility, and regulatory review. These photo simulations are intended to depict before and after conditions of the transmission line based on the most current design. Background imagery and landscaping in the after images may not accurately depict actual conditions once the project is constructed.



# Sammamish–Juanita Transmission Line Project

## SIMULATION VIEWPOINT 9

Date: 6/4/2014

Time: 10:33 AM

Viewing Direction: NORTHWEST

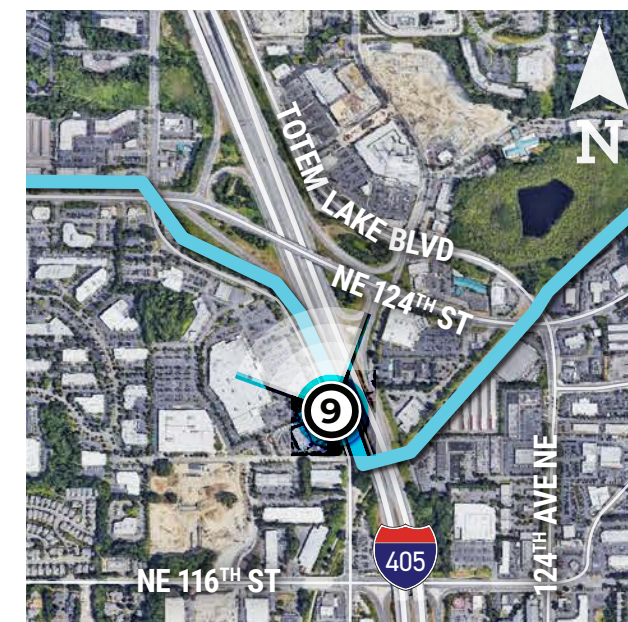

- ① PHOTO VIEWPOINT
- SUBSTATION
- TRANSMISSION LINE

Photo simulations created by:  



**EXISTING CONDITIONS**



**PROPOSED CONDITIONS GALVANIZED**

Photo simulations are for demonstration purposes only, and do not depict the exact location of any project improvements. Final design is subject to change pending public, utility, and regulatory review. These photo simulations are intended to depict before and after conditions of the transmission line based on the most current design. Background imagery and landscaping in the after images may not accurately depict actual conditions once the project is constructed.



# Sammamish–Juanita Transmission Line Project

## SIMULATION VIEWPOINT 10

Date: 9/19/2019

Time: 3:50 PM

Viewing Direction: WEST



- ① PHOTO VIEWPOINT
- SUBSTATION
- TRANSMISSION LINE

Photo simulations created by:



EXISTING CONDITIONS



PROPOSED CONDITIONS

Photo simulations are for demonstration purposes only, and do not depict the exact location of any project improvements. Final design is subject to change pending public, utility, and regulatory review. These photo simulations are intended to depict before and after conditions of the transmission line based on the most current design. Background imagery and landscaping in the after images may not accurately depict actual conditions once the project is constructed.



# Sammamish–Juanita Transmission Line Project

## SIMULATION VIEWPOINT 11

Date: 9/19/2019

Time: 4:02 PM

Viewing Direction: EAST

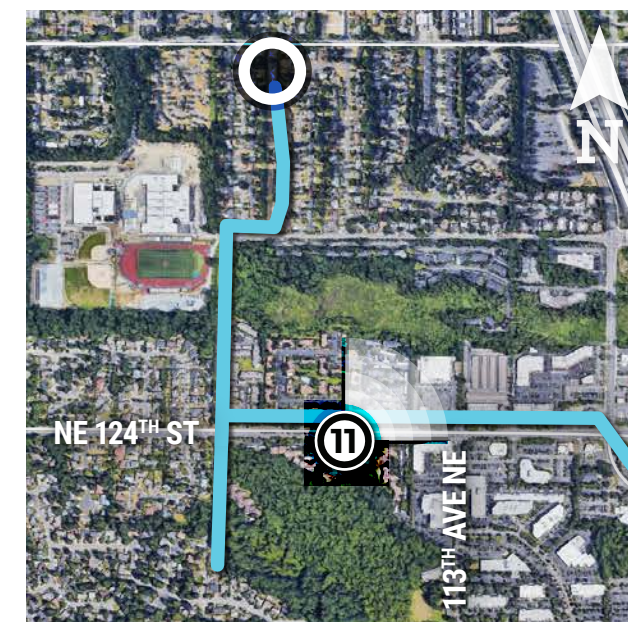

① PHOTO VIEWPOINT

● SUBSTATION

— TRANSMISSION LINE

Photo simulations created by:



EXISTING CONDITIONS

PROPOSED CONDITIONS

GALVANIZED

Photo simulations are for demonstration purposes only, and do not depict the exact location of any project improvements. Final design is subject to change pending public, utility, and regulatory review. These photo simulations are intended to depict before and after conditions of the transmission line based on the most current design. Background imagery and landscaping in the after images may not accurately depict actual conditions once the project is constructed.

